

CAT 6 UNSHIELDED TOOL-LESS IDC JACK

Description

RFI CAT 6 Unshielded Tool-less Keystone Jack features a twist lever locking housing that allows the installer to punch down and lock the termination in place, without tool.

Specifications

Electrical:

- Contact resistance: 20 milli-ohm
- Insulation resistance: $\leq 250\text{M ohm @}100\text{V DC}$
- Withstand voltage: DC1000V, AC700V_{rms}, 60Hz, I_{min}
- CAT6 permanent link, conform to: ANSI/TIA/EIA 568B. 2-10
- Testing condition of transmitting capability: 100MHz

Mechanical:

- Plastic material: new PC
- Gold pins: phosphor bronze, gold plating 3U"
- Terminal pins: phosphor bronze, zine plating
- RJ45 contact life: 750 times minimum
- IDC terminal life: 250 times minimum

Environmental:

- Storage: $-40^{\circ}/+70^{\circ}$
- Operation: $-10^{\circ}/+60^{\circ}$
- ROHS, REACH compliant

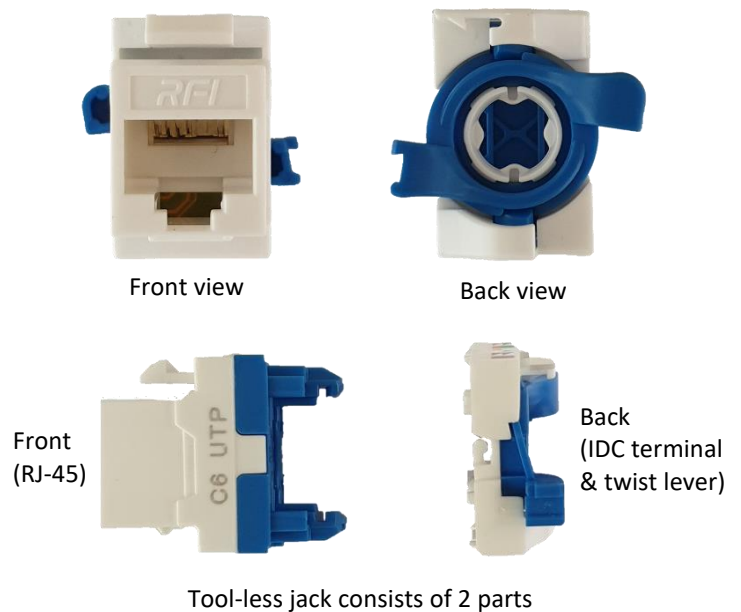

Termination Procedure

Step #1	Step #2	Step #3	Step #4	Step #5
If the 2 parts are locked together, lift up white plastic catch (1) slightly & release blue twist lever (2) as shown.	Push CAT6 cable through centre of the twist lever part.	Strip cable sheath, fan out wires & insert wires according to T568A or T568B wiring scheme.	Push the two parts firmly together & trim off excess wire ends.	Twist blue lever (clockwise) and lock (white plastic catch), no tool required.

Ordering information

Part No.	Description
RJD-60U8880-05B	CAT 6 UTP Pro Line 180° Tool-less Keystone Jack

The information given in this document may be amended. You are also reminded that all products must be installed by a qualified professional.